

Mini ball valves with T-handle on one side type compact EN 331 PN20



Materials

Housing :Chrome Nickel-plated Brass
 Ball :Chrome Nickel-plated Brass
 Seal :PTFE/NBR
 Handle :PA66 Glass reinforced Handle
 Stem seal:NBR Seal O-RING

Temperature range: -20°C to max. +80°C

Vacuum (max. -0.99 bar)

Area of application: water (no steam), neutral, gaseous and non-aggressive, liquid media, mineral oils, pressureair

Dimensions

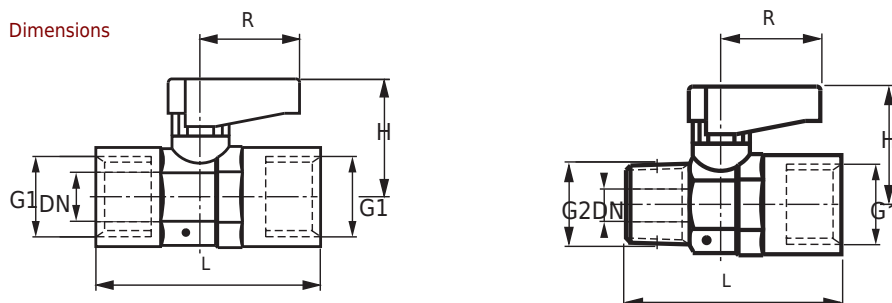

Type	G1	G2	DN	L	H	R
inner thread						
6622M00001	Rp 1/8"		5.5	36	21	19
6622M00002	Rp 1/4"		5.5	43	21	19
6622M00003	Rp 3/8"		8.0	47	22	19
6622M00004	Rp 1/2"		10.0	59	31	26
internal/external thread						
6622M10001	Rp 1/8"	R 1/8"	5.5	36	21	19
6622M10002	Rp 1/4"	R 1/4"	5.5	41	21	19
6622M10003	Rp 3/8"	R 3/8"	8.0	46	22	19
6622M10004	Rp 1/2"	R 1/2"	10.0	57	31	26

Threads:

Rp :Parallel gas in conformity with ISO 228 Class A.
 R :Taper Gas in conformity with ISO7.1, BS 21, DIN 2999.