

# MXT-F7329 - JIS 40K

## Forged Steel Globe Valve

Accordance to JIS F7400

Flanges as per JIS B2220 - JIS 40K

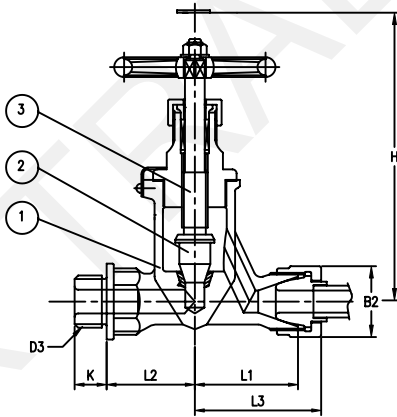

“S” Type

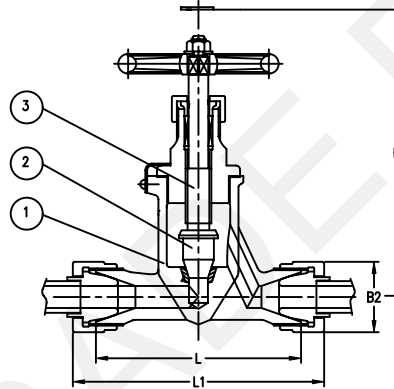

“U” Type

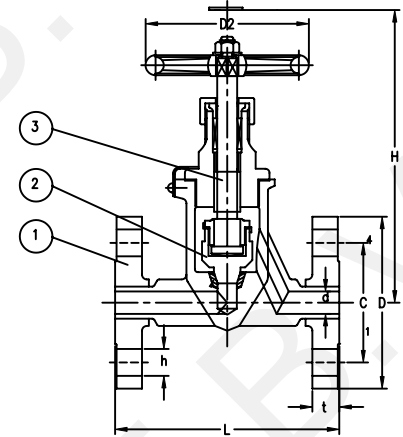

“F” Type

Part Nr.	Material
1 - Body	Forged Steel
2 - Stem	Stainless Steel
3 - Disc	Stainless Steel

	Test Pressure MPa [kg/cm <sup>2</sup> ]
Body	9.12 [93.0]
Seat	6.69 [68.2]

Type	Type of Connection	Nominal Dia.
S	Screw thread type	6 and 10
U	Union type	6 and 10
F	Flange type	15 to 25

	Size	L	L1	L2	L3	K	D	C	n	h	t	H	B2	D3	Kg
Type	6	-	42	38	51	12	-	-	-	-	-	150	30	M20x1.5	1.5
“S”	10	-	51	45	63	16	-	-	-	-	-	160	41	M42x2	1.8
Type	6	84	102	-	-	-	-	-	-	-	-	150	30	-	1.54
“U”	10	102	126	-	-	-	-	-	-	-	-	160	41	-	1.91
Type	15	150	-	-	-	-	115	80	4	19	20	215	-	-	5.91
“F”	20	170	-	-	-	-	120	85	4	19	20	250	-	-	7.4
	25	200	-	-	-	-	130	95	4	19	22	270	-	-	9.79

Information provided as an indication and subject to possible modification.  
Colours and details can be different then shown in data sheets or pictures.  
Merxtrade BV has no liability for any damages by use off any information,  
displayed on these pages.