

MXT-F7421 - JIS 20K

Forged Steel Globe Valve - Type "S", "U" and

Accordance to JIS F7400

"F"

Flanges as per JIS B2220 - 20K

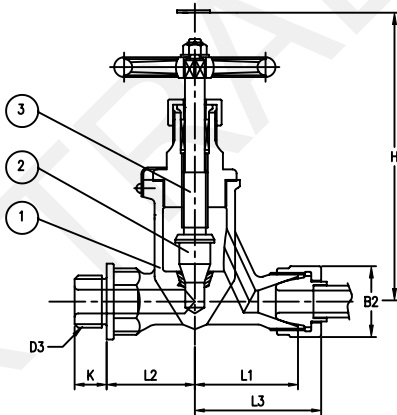

"S" Type

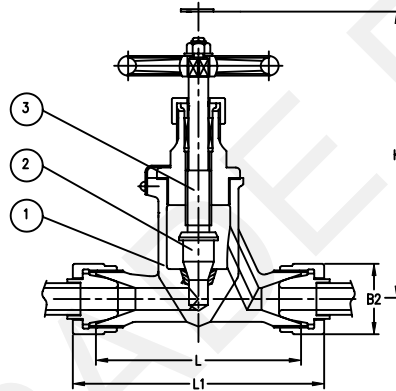

"U" Type

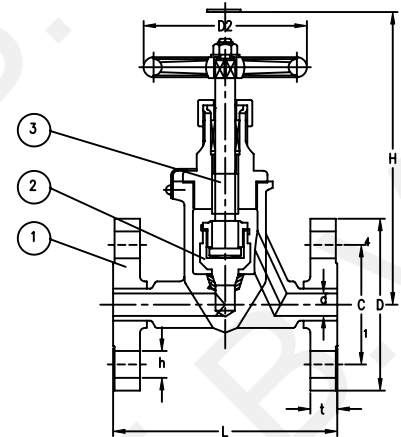

"F" Type

Part Nr.	Material
1 - Body	Forged Steel
2 - Stem	Stainless Steel
3 - Disc	Stainless Steel

	Test Pressure MPa [kg/cm ²]
Body	5.0 [51.0]
Seat	3.67 [37.4]

Type	Type of Connection	Nominal Dia.
S	Screw thread type	6 and 10
U	Union type	6 and 10
F	Flange type	15 to 25

	Size	L	L1	L2	L3	K	D	C	n	h	t	H	B2	D3	Kg
Type	6	-	42	38	51	12	-	-	-	-	-	125	30	M20x1.5	1.23
"S"	10	-	51	45	63	16	-	-	-	-	-	140	41	M42x2	1.59
Type	6	84	102	-	-	-	-	-	-	-	-	125	30	-	1.26
"U"	10	102	126	-	-	-	-	-	-	-	-	140	41	-	1.72
Type	15	140	-	-	-	-	95	70	4	15	14	180	-	-	3.90
"F"	20	160	-	-	-	-	100	75	4	15	16	205	-	-	5.29
	25	180	-	-	-	-	125	90	4	19	16	225	-	-	7.49

Information provided as an indication and subject to possible modification.
 Colours and details can be different then shown in data sheets or pictures.
 Merxtrade BV has no liability for any damages by use off any information,
 displayed on these pages.